



Sanlorenzo SL90A

2026
Year



27,6 m
Length

6,5 m
Beam



8



4 Cabins



4

Michisan

Sanlorenzo SL90A

The Sanlorenzo SL90A “MICHISAN” is a 27.6-meter luxury yacht designed to deliver an exclusive cruising experience across the Balearic Islands. Built in 2026 by Sanlorenzo, it combines contemporary elegance, high performance, and exceptional comfort. Thanks to its Zero Speed stabilizers, it ensures smooth navigation both at anchor and while cruising.

Its modern and sophisticated interior accommodates up to 8 guests in 4 en-suite cabins, including one master cabin and three VIP cabins. The spacious saloon, flooded with natural light through large panoramic windows, creates a cozy and relaxing atmosphere. Outside, the yacht features an impressive flybridge, lounge areas, and a hydraulic garage that transforms into a “Beach Club,” ideal for watersports or sunset drinks.



○ EXTRAS

Highlights: Lounge areas, wet bar, Wi-Fi, premium sound system.

Water toys: 2 x Seabob F9S, Williams 435 Sportjet tender, Sea-Doo GTX Limited 325 jet ski, Yacht-beach Premium Teak platform.

Raymarine navigation/electronics: Autopilot, digital anchor system, plotters, home automation system, joystick.

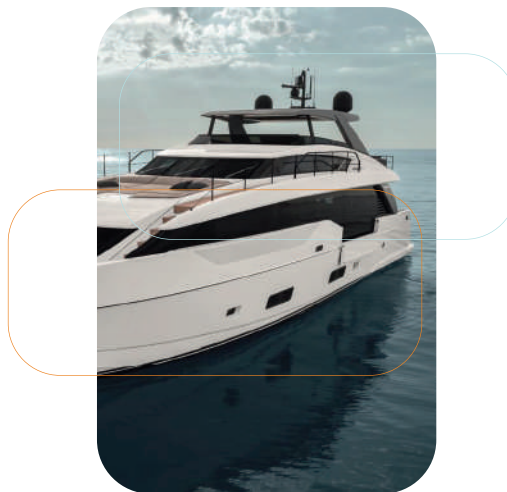

PRICES 2026 Denia ○

LOW SEASON

Rest of the year

Day	12.000 €
Week	85.000 €

HIGH SEASON

June 15th to September 15th

Day	14.000 €
Week	95.000 €

NOT INCLUDED

- * VAT 21%
- * APA 35%

○ CHARACTERISTICS

BLUEPRINTS



TECHNICAL SPECIFICATIONS

Length overall: 27.60 m / 90'6"

Beam: 6.50 m / 21'4"

Draft: 1.93 m / 6'4"

Displacement: 95 t

Engines: 2 × MAN 12V – 2000 HP

Cruising speed: 25 Kn

Maximum speed: 29 Kn

Economical speed: 10 Kn

Maximum range: 1,100 nm

Fuel consumption: Approx. 540 l/h

Hull material: Fiber

CAPACITY

Day: 12 guests / Nigth: 8 guests

ACCOMMODATION

4 cabins (1 Master + 3 VIP)

4 bathrooms + 1 crew bathroom

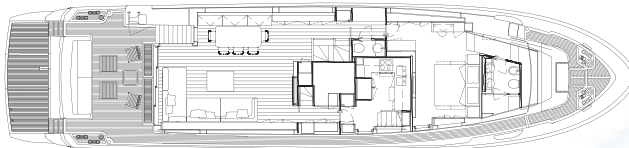
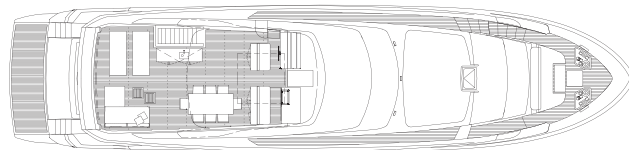

TANK CAPACITY

Fuel: 9,000 l

Fresh water: 1,700 l

Black water: 400 l

Grey water: 400 l

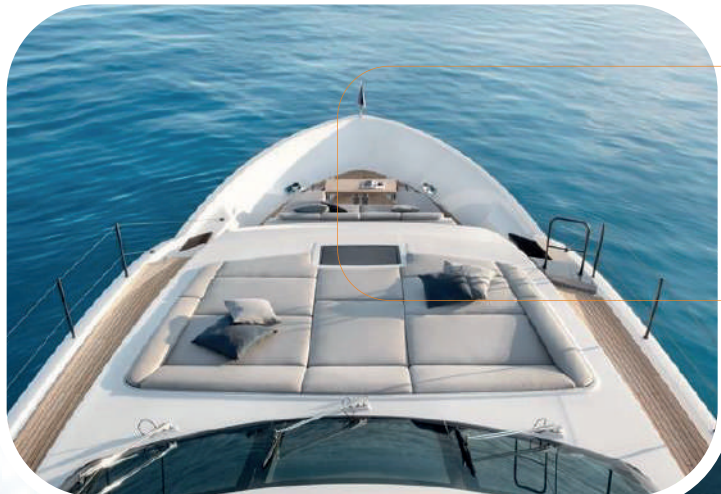

○ EXTERIOR

- Hydraulic Beach Club
- Flybridge
- Teak deck
- Sunbathing areas
- Swimming platform
- Hydraulic tender garage
- Carbon-fiber hard top





INTERIOR ○

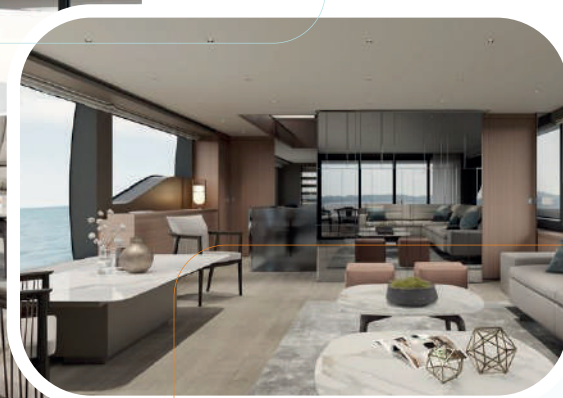

- Panoramic saloon
- Large windows
- Interior and exterior staircases
- Fiberglass flybridge
- Main saloon
- Kitchen
- Crew cabins